

Pin数	尺寸A	尺寸B	尺寸C
2x2	0.80	1.60	0
2x3	1.60	2.40	0.80
2x4	2.40	3.20	1.60
2x5	3.20	4.00	2.40
2x6	4.00	4.80	3.20
2x7	4.80	5.60	4.00
2x8	5.60	6.40	4.80
2x9	6.40	7.20	5.60
2x10	7.20	8.00	6.40
2x11	8.00	8.80	7.20
2x12	8.80	9.60	8.00
2x13	9.60	10.40	8.80
2x14	10.40	11.20	9.60
2x15	11.20	12.00	10.40
2x16	12.00	12.80	11.22
2x17	12.80	13.60	12.00
2x18	13.60	14.40	12.80
2x19	14.40	15.20	13.60
2x20	15.20	16.00	14.40
2x21	16.00	16.80	15.20
2x22	16.80	17.60	16.00
2x23	17.60	18.40	16.80
2x24	18.40	19.20	17.60
2x25	19.20	20.00	18.40
2x26	20.00	20.80	19.20
2x27	20.80	21.60	20.00
2x28	21.60	22.40	20.80
2x29	22.40	23.20	21.60
2x30	23.20	24.00	22.40
2x31	24.00	24.80	23.20
2x32	24.80	25.60	24.00
2x33	25.60	26.40	25.80
2x34	26.40	27.20	26.60
2x35	27.20	28.00	27.40
2x36	28.00	28.80	28.20
2x37	28.80	29.60	29.00
2x38	29.60	30.40	29.80
2x39	30.40	31.20	30.60
2x40	31.20	32.00	31.40
2x41	32.00	32.80	32.20
2x42	32.80	33.60	33.00
2x43	33.60	34.40	33.80
2x44	34.40	35.20	34.60
2x45	35.20	36.00	35.40
2x46	36.00	36.80	36.20
2x47	36.80	37.60	37.00
2x48	37.60	38.40	37.80
2x49	38.40	39.20	38.60
2x50	39.20	40.00	39.40

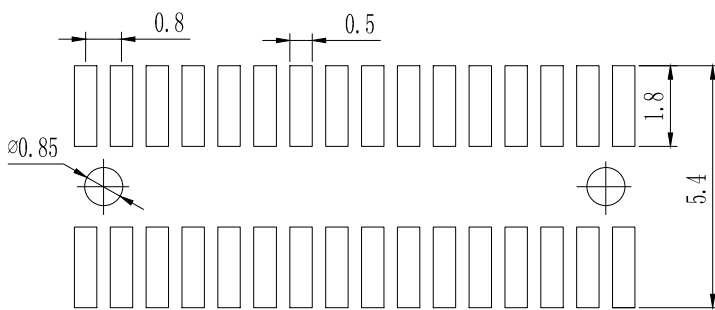

PCB LAYOUT

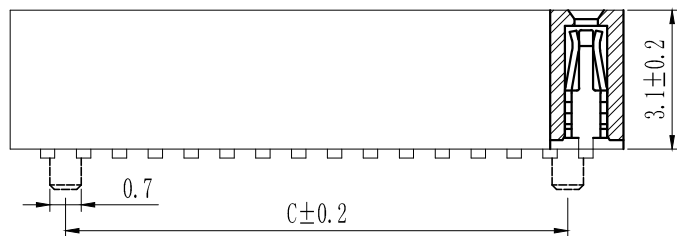
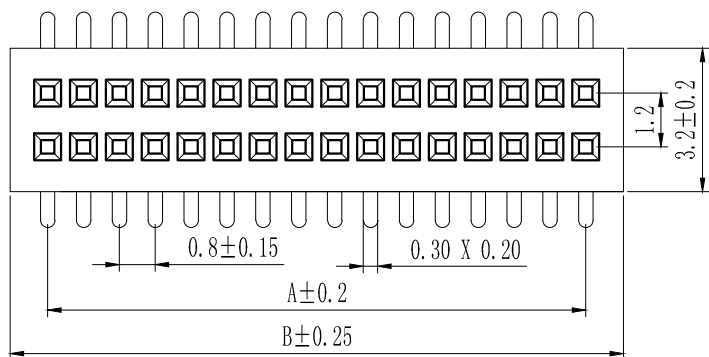
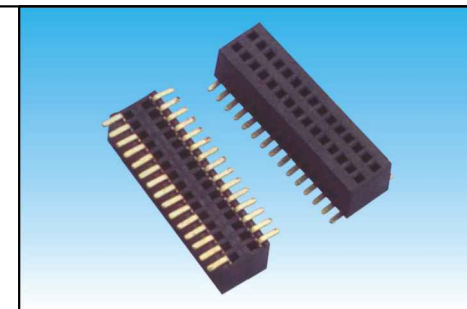
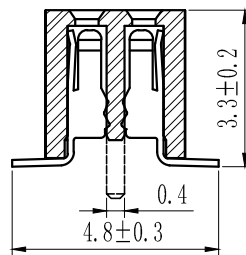
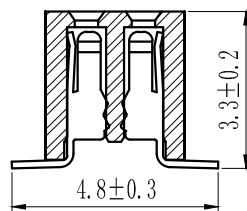

技术规范:

额定电流 : 0.75AMP

适用温度 : -40°C to +105°C

接触电阻 : 30mΩ Max

绝缘电阻 : 1000MΩ Min

耐电压 : AC 500V

绝缘材料 : Polyester (UL94V-0)

Standard: PA-6T

端子材质 : Bronze

电镀规范 : Au Over 50u" Ni

P a - 10 - 1 - 2 - 5p - a - a - s - D - 0										
排针系列	间距	塑高	双塑	单排	PIN位	电镀	材质	角度	端子	备注
	a=0.8mm		1-单塑	1-单排	1~40P/50P	A-1u"	A-PBT	S=180°	22.5mm即是225	0-3.0
	b=1.0mm		2-双塑	2-双排	2~40/50P	B-3u"	B-PA46	R=90°	11.6mm即是116	1-3.0/6.0(双塑)
	c=1.27mm		3-三塑	3-三排	3~40/50P	C-5u"	C-PA6T	M=SMT	12.2mm即是122	2-3.0/3.0(双塑)
	d=2.0mm			4-四排	4~40/50P	D-10u"	D-PA9T	Z-Z型	00Y=排母Y型端子	3-2.8/4.0(双塑)
	e=2.5mm					E-15u"	E-LCP	Y=135°	00U=排母U型端子	4-2.6/3.5(双塑)
	f=2.54mm					F-30u"		L=卧式SMT	00F=排母封口端子	其它另做说明
	g=3.96mm					S-镀锡			00Q=排母四面包端子	
	h=5.08mm					H-半金锡				注: 长短针以短针计

TOLERANCE:

X. ±XXX

.X ±0.20

.XX ±0.10

ANG.



上海狮拓电子科技有限公司

产品名称:

产品料号:

THIRD ANGLE PROJECTION



签名: \_\_\_\_\_

日期: \_\_\_\_\_

审核: \_\_\_\_\_

日期: \_\_\_\_\_

客户确认

承认 \_\_\_\_\_ 日期 \_\_\_\_\_

驳回 \_\_\_\_\_ 日期 \_\_\_\_\_

0.8mm双排母, SMT, 塑高3.1mm 可带内柱  
 Spec: 0.8mm Female Header, Dual Row, SMT with locating Peg  
 Positions: 2x2x2x50  
 Plastics Height: 0.8mm